

±0.1	0.1	Ra
±0.2	0.2	
±0.3	0.3	
±0.5	0.5	
±0.8	0.8	
0.5~5	1.6	
6~30	6.3	
31~120	25	
121~320		
321~1000		
GENERAL TOLERANCE		

HAITIMA CORPORATION  
 P.O.BOX 34-36 TAIPEI  
 Tel:+886-2-26585800  
 E-mail:haitima@seed.net.tw  
 www.haitima.com.tw  
 TAIWAN R.O.C.  
 Fax:+886-2-26582266

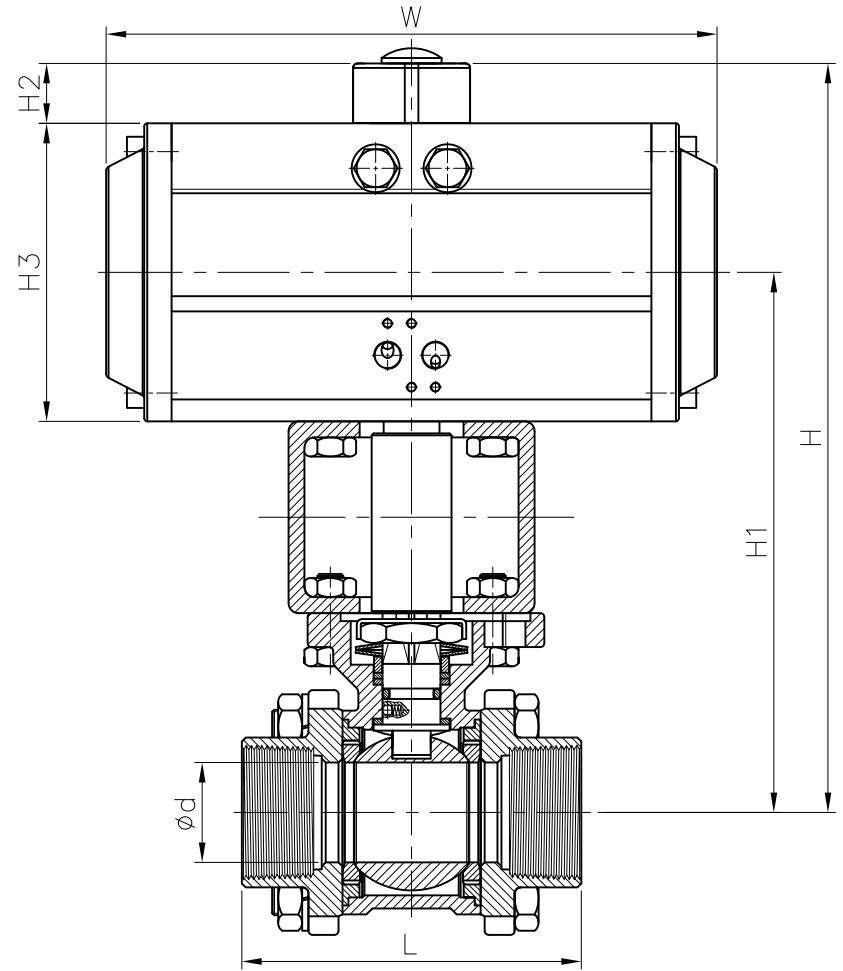

3/4"-HTS

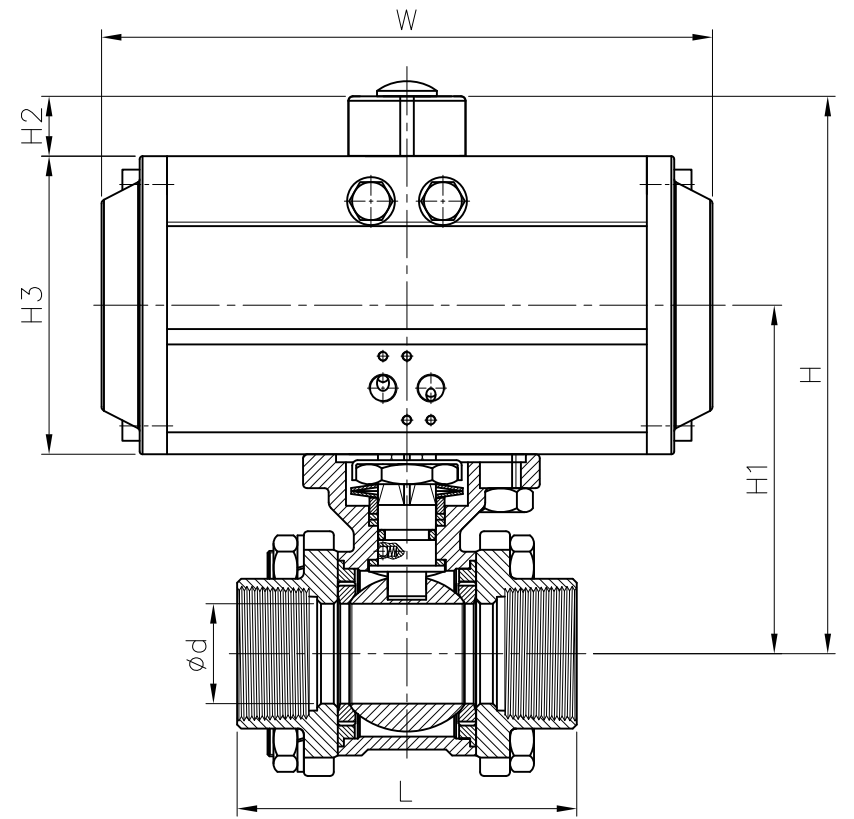

DN	d	W		L	H		H1		H2	H3		Actuators	
		HTS	HTD		HTS	HTD	HTS	HTD		HTS	HTD	HTS-052-10	HTD-032
15	15	157.5	110	65	130.4	100.4	73.4	58.9	20	74	45	HTS-052-10	HTD-032
20	20	190	157.5	75	195.5	133.5	131.5	76.5	20	88	74	HTS-063-10	HTD-052
25	25	190	157.5	85	157	143	93	86	20	88	74	HTS-063-10	HTD-052
32	32	205.5	157.5	101	174.2	148.2	104.2	91.2	20	100	74	HTS-075-10	HTD-052
40	38	211	190	112	193.6	172.6	119	108.6	20	109	88	HTS-083-10	HTD-063
50	50	259	205.5	130	212.5	192.5	132.5	122.5	20	120	100	HTS-092-10	HTD-075

unit:mm

NPS	d	W		L	H		H1		H2	H3		Actuators	
		HTS	HTD		HTS	HTD	HTS	HTD		HTS	HTD	HTS-052-10	HTD-032
1/2"	0.59	6.2	4.33	2.56	5.13	3.95	2.89	2.32	0.79	2.91	1.77	HTS-052-10	HTD-032
3/4"	0.79	7.48	6.2	2.95	7.7	5.26	5.18	3.01	0.79	3.46	2.91	HTS-063-10	HTD-052
1"	0.98	7.48	6.2	3.35	6.18	5.63	3.66	3.39	0.79	3.46	2.91	HTS-063-10	HTD-052
1-1/4"	1.26	8.09	6.2	3.96	6.86	5.83	4.1	3.59	0.79	3.94	2.91	HTS-075-10	HTD-052
1-1/2"	1.5	8.31	7.48	4.41	7.62	6.8	4.69	4.28	0.79	4.29	3.46	HTS-083-10	HTD-063
2"	1.97	10.2	8.09	5.12	8.37	7.58	5.22	4.82	0.79	4.72	3.94	HTS-092-10	HTD-075

unit:in

△			
△			
△			
Revise	Description	Date	Approve

DRAWING NO.

2013ND020HD - 12



HAITIMA CORPORATION  
 Ball Valves

CHECK BY	DRAWING BY	DATE	SPECIFICATION	3-PC Screwed End Ball Valve 1000 WOG
	Ray	Aug.22.2012	MATERIAL	ASTM A351-CF8M
			PROCESS/Nr.	
			UNIT / SCALE	mm

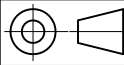

0.1	± 0.1	▽	Ra
0.2	± 0.2	▽	0.2
0.3	± 0.3	▽	1.6
0.5	± 0.5	▽	6.3
0.8	± 0.8	▽	25
1.0	± 1.0	▽	▽
1.2	± 1.2	▽	▽
1.5	± 1.5	▽	▽
2.0	± 2.0	▽	▽
2.5	± 2.5	▽	▽
3.0	± 3.0	▽	▽
4.0	± 4.0	▽	▽
5.0	± 5.0	▽	▽
6.3	± 6.3	▽	▽
8.0	± 8.0	▽	▽
10	± 10	▽	▽
12.5	± 12.5	▽	▽
16	± 16	▽	▽
20	± 20	▽	▽
25	± 25	▽	▽
31.5	± 31.5	▽	▽
40	± 40	▽	▽
50	± 50	▽	▽
63	± 63	▽	▽
80	± 80	▽	▽
100	± 100	▽	▽
125	± 125	▽	▽
160	± 160	▽	▽
200	± 200	▽	▽
250	± 250	▽	▽
315	± 315	▽	▽
400	± 400	▽	▽
500	± 500	▽	▽
630	± 630	▽	▽
800	± 800	▽	▽
1000	± 1000	▽	▽

HAITIMA CORPORATION  
 P.O.BOX 34-36 TAIPEI  
 Tel:+886-2-26585800  
 E-mail:haitima@seed.net.tw  
 TAIWAN R.O.C. www.haitima.com.tw  
 Fax:+886-2-26582266

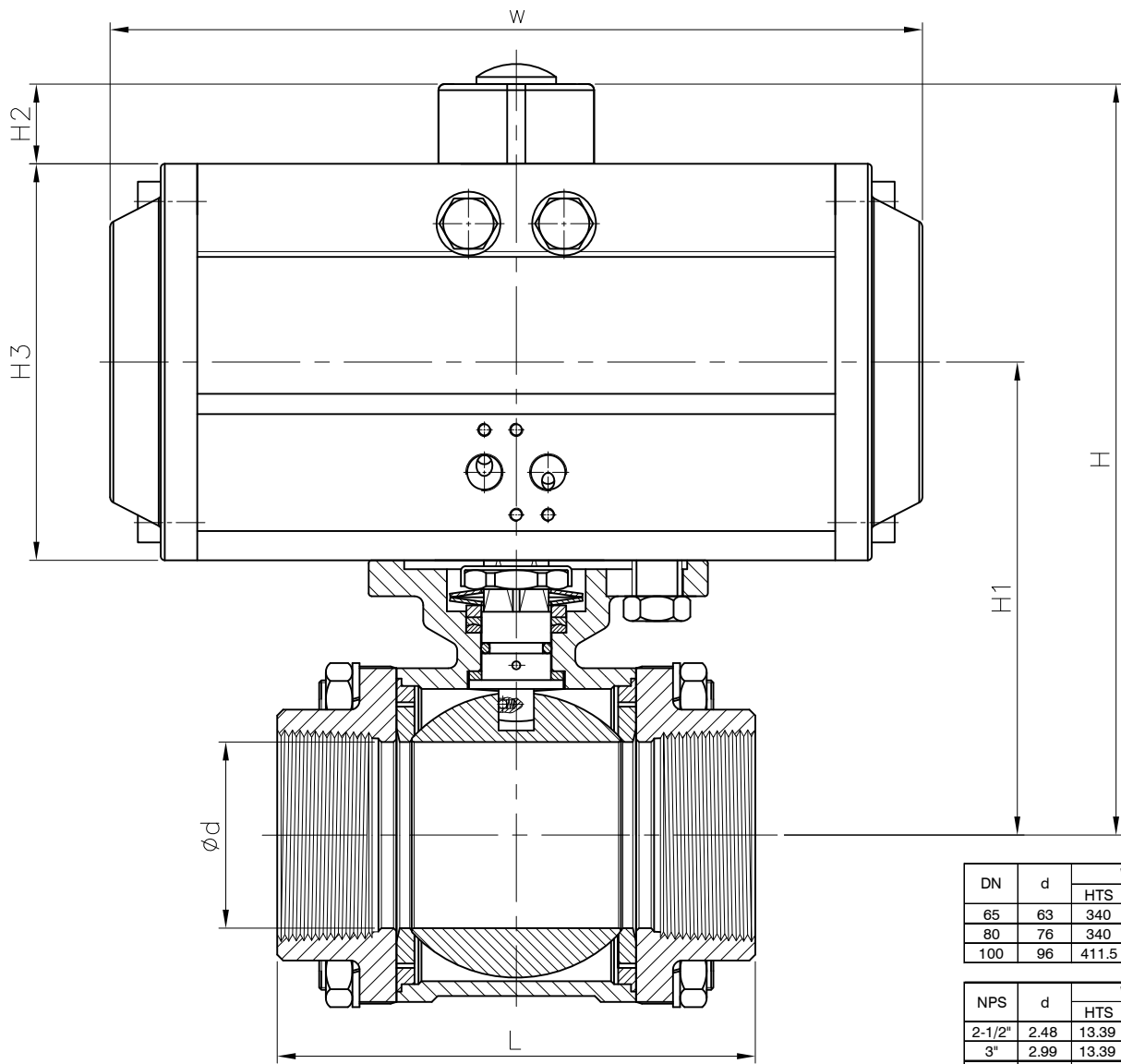

DN	d	W		L	H		H1		H2	H3		Actuators	
		HTS	HTD		HTS	HTD	HTS	HTD		HTS	HTD	HTS	HTD
65	63	340	259	162	267	232	169.5	152	20	155	120	HTS-125-10	HTD-092
80	76	340	259	188	275	240	177.5	160	20	155	120	HTS-125-10	HTD-092
100	96	411.5	285	224	324	285	217.8	198.5	20	171.5	133	HTS-140-10	HTD-105

unit:mm

NPS	d	W		L	H		H1		H2	H3		Actuators	
		HTS	HTD		HTS	HTD	HTS	HTD		HTS	HTD		
2-1/2"	2.48	13.39	10.2	6.38	10.51	9.13	6.67	5.98	0.79	6.1	4.72	HTS-125-10	HTD-092
3"	2.99	13.39	10.2	7.4	10.83	9.45	6.99	6.3	0.79	6.1	4.72	HTS-125-10	HTD-092
4"	3.78	16.2	11.22	8.82	12.76	11.22	8.57	7.81	0.79	6.75	5.24	HTS-140-10	HTD-105

unit:in

△			
△			
△			
Revise	Description	Date	Approve

**HAITIMA CORPORATION**  
 Ball Valves

CHECK BY	DRAWING BY	DATE	SPECIFICATION	3-PC Screwed End Ball Valve 1000 WOG
	Ray	Aug.23.2012	MATERIAL	ASTM A351-CF8M
			PROCESS/Nr.	
			UNIT / SCALE	mm

DRAWING NO. **2013ND021HD - 12**